

Clutch Assembly

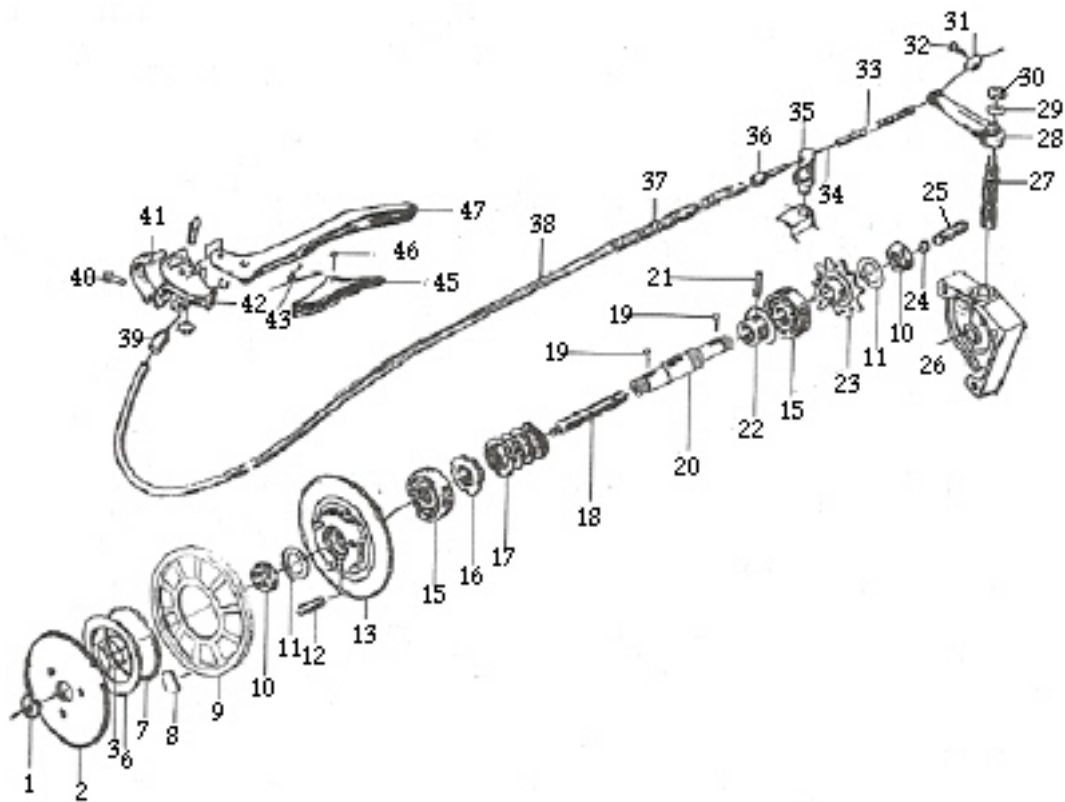

- | | |
|-------------------------------|----------------------------------|
| 1) Clutch Plate Retaining Nut | 16) Adjusting Nut |
| 1 a) Set Screw for plate nut | 17) Clutch Spring |
| 2) Clutch Plate | 18) Mandrel |
| 3) Coil Spring | 19) Carter Key Way |
| 6) Ball Bearing Race | 20) Drive Shaft |
| 7) Ball Bearings | 22) Ferrule |
| 8) Friction Pad | 23) Drive Sprocket / Chain Wheel |
| 9) Ring Gear | 24) DIA 8 Steal Ball |
| 10) M14 Nut | 25) Cam Pin |
| 11) M14 Lock Washer | 26) Bucking Bar |
| 12) Fixed Pin | 27) Cam Shaft |
| 13) Clutch Base | 28) Clutch lever linkage |
| 15) Crank Shaft Ball Bearing | 29) M6 Flat Washer |

- 30) M6 Nut
 31-39) Clutch Cable Kit
 40-47) Clutch Handle Assembly